

PROPOSED CONSTRUCTION AND EQUIPPING

OF 3NO.CLASSROOMS

AT

KAVILILA PRIMARY SCHOOL

IN

MASINGA CONSTITUENCY

MACHAKOS COUNTY

**NATIONAL GOVERNMENT CONSTITUENCIES
DEVELOPMENT FUND BOARD**
17 JUN 2022
**CORPORATE SOCIAL RESPONSIBILITY
PROGRAMME**

| ITEM NO | DESCRIPTION | QTY | UNIT | RATE | SHS |
|---------|--|------|------|------|--------|
| | <u>ENVIRONMENTAL CONSERVATION</u> | | | | |
| A | The Contractor shall plant trees immediately the site is handed over as directed by County Works Officer and Head Teacher and water during contract period till well established | ITEM | | SUM | 20,000 |
| | <u>SUBSTRUCTURE</u> | | | | |
| | 1.If site is sloping, flatten site before construction commences and where possible Building should be along contours and not across same. | | | | |
| | 2. Substructure Walling should on average be 300mm above flattened ground. | | | | |
| | <u>ALL PROVISIONAL</u> | | | | |
| A | Clear site of bushes, grass and debris and cart away and burn | 271 | SM | | |
| B | Excavate oversite 150mm deep to remove vegetable soil and cart away and deposit as directed | 271 | SM | | |
| C | Excavate to reduce levels commencing from stripped ground level | 40 | CM | | |
| D | Excavate for trench not exceeding 1.50 metres deep from stripped ground | 69 | CM | | |
| E | Extra over for excavation in rock of any class | 6 | CM | | |
| F | Cart away excavated material and deposit in council approved dump | 73 | CM | | |
| G | Return, fill and ram selected material to back of foundations | 37 | CM | | |
| H | Allow for planking and strutting to uphold sides of excavations | ITEM | | SUM | |
| I | Allow for keeping excations free from general water including spring water by pumbing or otherwise | ITEM | | SUM | |
| J | Hardcore fill in making up levels laid and compacted in layers of 150 mm thick and overall thickness 300 mm | 253 | SM | | |
| | Carried to Collection | | | | |

NATIONAL GOVERNMENT CONSTITUENCIES
 DEVELOPMENT FUND BOARD
 17 JUN 2022
 CORPORATE SOCIAL RESPONSIBILITY
 PROGRAMME

| ITEM NO | DESCRIPTION | QTY | UNIT | RATE | SHS |
|---------|--|-----|------|------|-----|
| A | Treat surface of stripped ground with chloropyrif or antitermite treatment applied in accordance with the manufacturer' printed instructions | 268 | SM | | |
| B | Murram blinding laid on hardcore(ms) | 253 | SM | | |
| C | Gauge 500 damp proof membrane | 268 | SM | | |
| | <u>Concrete Work</u> | | | | |
| | <u>Plain Concrete Class mix (1:4:8) in:</u> | | | | |
| D | 50 mm Thick blinding under column bases and strip foundations | 51 | SM | | |
| | <u>Vibrated Reinforced concrete mix (1:2:4) in:-</u> | | | | |
| E | Strip foundations | 10 | CM | | |
| F | 100 mm Thick floor bed | 268 | SM | | |
| G | 100 Ditto ramp 1200 mm wide and 3000 mm long including 20mm thick cement and sand screed (1:3) with grooves in approved pattern | 1 | NO | | |
| H | Concrete site step size 1200x500 mm ,200 mm step and 165 mm high | 8 | LM | | |
| | Carried to Collection | | | | |
| | 2 | | | | |

NATIONAL GOVERNMENT CONSTITUENCIES
DEVELOPMENT FUND BOARD

17 JUN 2022

CORPORATE SOCIAL RESPONSIBILITY
PROGRAMME

| ITEM NO | DESCRIPTION | QTY | UNIT | RATE | SHS |
|---------|---|-----|------|------|-----|
| A | 50 mm Thick precast concrete paving slabs (1:2:4) with joints in cement mortar (1:4) pointed and laid on murrum and hardcore bed including excavating 150 mm deep | 45 | SM | | |
| | <u>REINFORCEMENT</u> | | | | |
| | <u>Supply and fix the following high tensile ribbed round steel bars to B.S. 4461 including binding wires, spacer blocks ,cutting and bending</u> | | | | |
| B | 10 mm Diameter bars | 211 | KG | | |
| C | 8mm Ditto | 101 | KG | | |
| D | BRC Fabric REF. A142 weighing 2.20 KGS per square metres including side and end laps, stools and binding wire | 268 | SM | | |
| | Carried to collection | | | | |
| | 3 | | | | |

NATIONAL GOVERNMENT CONSTITUENCIES
 DEVELOPMENT FUND BOARD
 17 JUN 2022
 CORPORATE SOCIAL RESPONSIBILITY
 PROGRAMME

| ITEM NO | DESCRIPTION | QTY | UNIT | RATE | SHS |
|------------|---|-----|------|------|-----|
| | <u>COLLECTION</u> | | | | |
| | From page 1 | | | | |
| | " " 2 | | | | |
| | " " 3 | | | | |
| | " " 4 | | | | |
| | TOTAL FOR SUBSTRUCTURE CARRIED TO MAIN SUMMARY | | | | |
| | 5 | | | | |

NATIONAL GOVERNMENT CONSTITUENCIES
 DEVELOPMENT FUND BOARD
 17 JUN 2022
 CORPORATE SOCIAL RESPONSIBILITY
 PROGRAMME

| ITEM NO | DESCRIPTION | QTY | UNIT | RATE | SHS |
|---------|--|-----|------|------|-----|
| | <u>REINFORCED CONCRETE SUPERSTRUCTURE</u> | | | | |
| | <u>Vibrated Reinforced Concrete mix class 25/20 with crushing strength of 25N/mm²</u> | | | | |
| A | Ring Beams | 4 | CM | | |
| | <u>REINFORCEMENT</u> | | | | |
| | <u>Supply and fix the following high tensile ribbed steel bars as before :</u> | | | | |
| B | 12 mm Diameter bars | 249 | KG | | |
| C | 8 mm Ditto | 125 | KG | | |
| | Carried to collection | | | | |
| | 6 | | | | |

NATIONAL GOVERNMENT CONSTITUENCIES
DEVELOPMENT FUND BOARD
17 JUN 2022
CORPORATE SOCIAL RESPONSIBILITY
PROGRAMME

| ITEM NO | DESCRIPTION | QTY | UNIT | RATE | SHS |
|---|--|-----|------|------|-----|
| A | <u>Sawn formwork to:-</u> Sides and soffits of beams <u>MILD STEEL</u> | 56 | SM | | |
| B | 75mm Diameter hollow section tubular pillar 2800 mm high with 100x100 x3 mm base plate welded on with 4NO. 12 mm diameter anchor bolts with nut and washers and form holes in base plate | 10 | NO | | |
| C | <u>Painting and Decorating</u> Prepare and apply one undercoat and two coats gloss oil paint to general surfaces of metal | 28 | LM | | |
| D | <u>SUNDRY</u> <u>WELD ON</u> 100X50 x2mm Plate with 4NO.10 mm bolts 150 mm long with nut and washers and form holes in mild steel and timber | 10 | NO | | |
| E | <u>Second grade celcured Cypress:</u> 100X50 mm Wall plate to steel pillars (MS) Carried to collection <u>COLLECTION</u> From page 6 " Above | 28 | LM | | |
| TOTAL FOR REINFORCED CONCRETE SUPERSTRUCTURE CARRIED TO MAIN SUMMARY | | | | | |
| 7 | | | | | |

**NATIONAL GOVERNMENT CONSTITUENCIES
DEVELOPMENT FUND BOARD**

17 JUN 2022

 CORPORATE SECRETARY
 PROGRAMME

| ITEM NO | DESCRIPTION | QTY | UNIT | RATE | SHS |
|---------|---|-----|------|------|-----|
| | <u>WALLING</u> | | | | |
| | <u>EXTERNAL WALLING</u> | | | | |
| | Natural stone machine cut , with crushing strength of 14.00 N/MM2 bedded in cement and sand (1:4) mortar joints reinforced with hoop as before: | | | | |
| A | 150 mm Thick walls | 147 | SM | | |
| B | 150mm Ditto in gables | 18 | SM | | |
| C | 150x300 mm Piers | 65 | LM | | |
| D | 150 mm Wide damp proof course laid in cement and sand (1:4) bed | 70 | LM | | |
| E | Extra over medium chisel dressed walling for neatly recessed horizontal joints | 147 | SM | | |
| | <u>INTERNAL WALLING</u> | | | | |
| F | 150 mm Thick machine cut stone in cement and sand mortar joints (1:4) | 42 | SM | | |
| G | 150X200 mm Precast concrete permanent vents with mosquito gauze wire build in walling | 8 | PR | | |
| H | 150 mm Wide damp proof as before described | 16 | LM | | |
| | <u>Sundry</u> | | | | |
| I | Raking cutting on 150 mm thick walls | 40 | LM | | |
| J | Eaves filling on 150mm thick walling and 300mm average height | 62 | LM | | |
| | TOTAL FOR WALLING CARRIED TO MAIN SUMMARY | | | | |
| | 8 | | | | |

NATIONAL GOVERNMENT CONSTITUENCIES
 DEVELOPMENT FUND BOARD
 17 JUN 2022
 CORPORATE SOCIAL RESPONSIBILITY
 PROGRAMME

| ITEM NO | DESCRIPTION | QTY | UNIT | RATE | SHS |
|---------|---|-----|------|------|-----|
| | <u>ROOFING</u> | | | | |
| | <u>ROOF CONSTRUCTION</u> | | | | |
| | <u>TIMBER TRUSSES</u> | | | | |
| | <u>Fabricate, bolt and hoist the following 16NO.Trusses span 9.80 metres and hoist and fix 3.00 metre above ground:</u> | | | | |
| | <u>Second grade celcured cypress:</u> | | | | |
| A | 150x50 mm Rafters | 190 | LM | | |
| B | 150x50 Ceiling joists/tie beams | 157 | LM | | |
| C | 100x50 Struts and ties | 190 | LM | | |
| D | 100X50 mm King post | 34 | LM | | |
| | <u>Sundry</u> | | | | |
| E | 12 mm Diameter rawl bolts 200 mm long with washers | 51 | NO | | |
| | <u>END OF TRUSSES</u> | | | | |
| | <u>General Construction</u> | | | | |
| F | 100X50 mm Wall plate | 54 | LM | | |
| I | 75X50 mm Purlins | 335 | LM | | |
| | <u>ROOF COVERING</u> | | | | |
| J | Pre-painted gauge 28 galvanised corrugated roofing sheets with side and end laps including brass 'J' bolts with plastic caps to suppliers's specification | 331 | SM | | |
| K | Ridge and hip cap in matching sheet | 28 | LM | | |
| | <u>Wrot Cypress</u> | | | | |
| L | 200X25 mm Fascia and Barge board | 80 | LM | | |
| | <u>Painting and Decorating</u> | | | | |
| M | Prepare and apply one under coat and three finishing coats of gloss oil paint to general surfaces of wood work 200 to 300 mm girth | 80 | LM | | |
| | Carrie to Collection | | | | |
| | 9 | | | | |



| ITEM NO | DESCRIPTION | QTY | UNIT | RATE | SHS |
|---------|---|-----|------|------|-----|
| | <u>Rainwater Goods</u> | | | | |
| A | 100 mm Diameter half round plastic eaves gutters supported with brackets at 1000 mm centres | 56 | LM | | |
| B | Extra over for 600 mm long swanneck | 4 | NO | | |
| C | Ditto stopped ends | 4 | NO | | |
| D | Ditto outlets | 4 | NO | | |
| E | Ditto bends | 4 | NO | | |
| F | 75 mm Diameter down pipe held with pipe clips to walling | 12 | LM | | |
| G | Extra over for offset | 4 | NO | | |
| | Carried to Collection | | | | |
| | <u>COLLECTION</u> | | | | |
| | From Page 9 | | | | |
| " | " 10 | | | | |
| | TOTAL FOR ROOF CARRIED TO MAIN SUMMARY | | | | |
| | 10 | | | | |

NATIONAL GOVERNMENT CONSTITUENCIES
 DEVELOPMENT FUND BOARD
 17 JUN 2022
 CORPORATE SOCIAL RESPONSIBILITY
 PROGRAMME

NATIONAL GOVERNMENT CONSTITUENCIES
DEVELOPMENT FUND BOARD
17 JUN 2022
CORPORATE SOCIAL RESPONSIBILITY
PROGRAMME

| ITEM NO | DESCRIPTION | QTY | UNIT | RATE | SHS |
|---------|--|-----|------|------|-----|
| | <u>Ironmongery</u> | | | | |
| A | Two lever mortice lock and furniture including matching screws as Union | 0 | NO | | |
| B | Heavy duty bush hinges | 6 | NO | | |
| C | Rubber stops | 6 | NO | | |
| | <u>Painting and Decorating</u> | | | | |
| | <u>Externally</u> | | | | |
| D | Prepare and apply three coats of gloss oil paint from Crown Berger or Dura Coat to general surfaces of metal | 9 | SM | | |
| | <u>Internally</u> | | | | |
| E | Prepare and apply three coats as before | 9 | SM | | |
| | Carried to Collection | | | | |
| | <u>COLLECTION</u> | | | | |
| | From Page 11 | | | | |
| | " " 12 | | | | |
| | TOTAL FOR DOORS CARRIED TO MAIN SUMMARY | | | | |

12



| ITEM NO | DESCRIPTION | QTY | UNIT | RATE | SHS |
|---------|---|-----|------|------|-----|
| | <u>WINDOWS</u> | | | | |
| | <u>Mild Steel</u> | | | | |
| | <u>Fabricate ,Supply and fix including ground smooth weld joints with ' I' sections and 25x25 mm ' Z' sections prepare and apply red oxide primer before delivery including brass window stays and fasteners to Architect's approval:</u> | | | | |
| A | Composite window size 1800x1500 mm consisting of 2NO. opening lights size 600x1500mm , 1NO.fixed light and ventlight | 9 | NO | | |
| B | Ditto 1800x1000 mm Ditto, 2NO. Opening lights, 1NO. fixed light and ventlight | 6 | NO | | |
| | <u>Glazing</u> | | | | |
| C | 4mm Thick clear glass in panes 0.10 to 0.50 square metres and glazing metal with linseed oil putty | 36 | SM | | |
| | <u>Precast Concrete</u> | | | | |
| D | 265X75 mm Window cill in concrete (1:2:4) including moulds, throating, top weathered and hoist and fix in position | 29 | LM | | |
| | Carried to Collection | | | | |
| | 13 | | | | |

NATIONAL GOVERNMENT CONSTITUENCIES
 DEVELOPMENT FUND BOARD
 17 JUN 2022
 CORPORATE SOCIAL RESPONSIBILITY
 PROGRAMME

| ITEM NO | DESCRIPTION | QTY | UNIT | RATE | SHS |
|---------|---|-----|------|------|-----|
| | <u>Painting and Decorating</u> | | | | |
| | <u>Internally</u> | | | | |
| A | Prepare and apply one under coat and three coats of gloss oil paint from Crown Berger or Dura Coat to general surfaces of metal | 36 | SM | | |
| | <u>Externally</u> | | | | |
| B | Ditto Surfaces of metal | 36 | SM | | |
| | Carried to Collection | | | | |
| | <u>COLLECTION</u> | | | | |
| | From Page 13 | | | | |
| | " " 14 | | | | |
| | TOTAL FOR WINDOWS CARRIED TO MAIN SUMMARY | | | | |
| | 14 | | | | |

NATIONAL GOVERNMENT CONSTITUENCY:
 DEVELOPMENT FUND BOARD
 17 JUN 2022
 CORPORATE SOCIAL RESPONSIBILITY
 PROGRAMME

| ITEM NO | DESCRIPTION | QTY | UNIT | RATE | SHS |
|---------|--|-----|------|------|-----|
| | <u>FINISHES</u> | | | | |
| | <u>EXTERNAL FINISHES</u> | | | | |
| A | 12 mm Thick cement and sand (1:4) rendering to concrete surfaces woodfloat finished | 21 | SM | | |
| B | 12 mm Ditto to walls and reveals | 17 | SM | | |
| C | 12 mm Ditto to gables | 17 | SM | | |
| | <u>Painting and Decorating</u> | | | | |
| D | Prepare and apply three coats plastic emulsion paint from Crown Berger or Dura Coat to rendered surfaces | 55 | SM | | |
| | <u>Internal Wall Finishes</u> | | | | |
| E | 12 mm Thick plaster plus cement and sand (1:4) steel float finished | 256 | SM | | |
| | <u>Painting and Decorating</u> | | | | |
| F | Prepare and apply three coats plastic emulsion vinyl silk cream paint from Crown Berger or Dura Coat to plastered surfaces | 256 | SM | | |
| G | Extra over plastering for black board and prepare and apply three coats of bitumastic paint ditto | 32 | SM | | |
| | Carried to Collection | | | | |
| | 15 | | | | |

NATIONAL GOVERNMENT CONSTITUENCIES
 DEVELOPMENT FUND BOARD
 17 JUN 2022
 CORPORATE SOCIAL RESPONSIBILITY
 PROGRAMME

| ITEM NO | DESCRIPTION | QTY | UNIT | RATE | SHS |
|---------|---|-----|------|------|-----|
| | <u>Floor Finishes</u> | | | | |
| A | 20 mm Thick cement and sand (1:3) floor screed wood float finished to receive tiles (M.S) | 253 | SM | | |
| | <u>CERAMIC TILES</u> | | | | |
| B | 8 mm Thick ceramic floor tiles size 300x300 mm laid with cement grout and joints pointed with white cement | 253 | SM | | |
| C | 8 mm Ditto and 100 mm high skirting | 120 | LM | | |
| | <u>Ceiling</u> | | | | |
| D | 12 mm Thick chip board ceiling fixed in symmetrical pattern | 253 | SM | | |
| E | Extra over ceiling for 600x600 mm trap door with 75x25 mm cornice all round and framing | 3 | NO | | |
| F | 75X25 mm Cornice with moulding | 127 | LM | | |
| | <u>Second grade celcured cypress</u> | | | | |
| G | 50X50 mm Branderings | 802 | LM | | |
| H | 50X50 mm Branderings but plugged | 127 | LM | | |
| | <u>Painting and Decorating</u> | | | | |
| I | Prepare and apply three coats of plastic emulsion paint to general surfaces of soft board (Brilliant white) | 253 | SM | | |
| J | General surfaces to 100 mm girth | 127 | LM | | |
| | Carried to Collection | | | | |

16



| ITEM NO | DESCRIPTION | QTY | UNIT | RATE | SHS |
|---------|--|-----|------|------|-----|
| | <u>FIXTURES</u> | | | | |
| | The following in 3NO.Black Board size 5000x1500 mm | | | | |
| A | 12 mm Thick plaster (1:4) to walls as before | 23 | SM | | |
| B | Prepare and apply three coats of black matt to walls | 23 | SM | | |
| C | 50X25 mm Wrot Cypress moulded bead with groove at bottom for chalk framing round board plugged and duster holder | 39 | LM | | |
| | The following in 3NO.Notice Board size 2400x1200 mm | | | | |
| D | 12 mm Thick soft board | 9 | SM | | |
| E | 50X25 mm Wrot Cypress moulded framing plugged | 22 | LM | | |
| | <u>Painting and Decorating</u> | | | | |
| F | Prepare and apply one under coat and three coats of brilliant white emulsion paint to general surfaces of soft board | 9 | SM | | |
| G | Prepare and apply one under coat and three coat of gloss oil paint to general surfaces of wood work to 100 mm girth | 22 | LM | | |
| | Carried to Collection | | | | |

18

NATIONAL GOVERNMENT CONSTITUENCY
DEVELOPMENT FUND BOARD

17 JUN 2022

CORPORATE SOCIAL RESPONSIBILITY
PROGRAMME

| ITEM NO | DESCRIPTION | QTY | UNIT | RATE | SHS |
|---------|--|-------------|----------------|------|-----|
| | <u>ELECTRICAL INSTALLATION</u> <u>ELECTRICAL WORKS TO BE EXECUTED BY SPECIALIST REGISTERED BY KPLC</u> <u>Supply , install , test and commission the following:</u> | | | | |
| A | Lighting points wired in 3x1.5mm ² SC PVC CU cables drawn in 20mm dia HG PVC conduits with all necessary accessories excluding switches and fittings for one way switching | 29 | NO | | |
| B | 10A moulded ivory switch plate as crabtree or approved equivalent as follows: i. Two way one gang | 3 | NO | | |
| | ii. Three way one gang | 1 | NO | | |
| C | Lighting fittings complete with fixing accessories and lamps as follows: i). 1200mm lx 36w florescent batten fitting or slim cross section with clip on cover plate and adjustable end cap system as Thorn Popular Pack batten or approved equivalent | 21 | NO | | |
| D | ii) Bulkhead fitting with aluminium body on Thorn or approved equivalent with Energy saving bulb | 8 | NO | | |
| E | Socket outlets Power outlets i. Comprising of wiring in 3x2.5mm ² PVC SC CU in concealed HG conduits | 6 | NO | | |
| | ii. 13A 2gang switched moulded socket outlet as crabtree or approved equivalent | 3 | NO | | |
| F | Consumer Units and Distribution Boards 4-Way SP/N consumer unit flush mounted on wall complete with a 10A SP/N integral isolator as crabtree or approved equivalent | 1 | NO | | |
| G | Single Pole miniature circuit breaker as follows: i. 5ASP ii. 30asp iii. Blanking covers | 1 2 1 | NO NO NO | | |
| | Carried to Collection | 21 | | | |



| ITEM NO | DESCRIPTION | QTY | UNIT | RATE | SHS |
|--|--|------|------|------|-----|
| A | Sub-mains Cables 3x6.0mm ² SCPVC CU cables drawn in HG conduit | 10 | LM | | |
| B | Standard cable looping box complete with single cut out fuse neutral link | 1 | NO | | |
| C | Electrical earthing comprising of 6.0mm ² SC PVC CU cable drawn in HG conduits 1500mm times 15mm copper electrodes c/w clamps pre-cast concrete inspection pit with cover | ITEM | | SUM | |
| D | Testing and commissioning | ITEM | | SUM | |
| E | Allow for supply and fixing Copper Lighting arrestors, w | 1 | NO | | |
| | Carried to Collection | | | | |
| | <u>COLLECTION</u> | | | | |
| | From Page 21 | | | | |
| | " " 22 | | | | |
| TOTAL FOR ELECTRICAL INSTALLATION CARRIED TO SUMMARY | | | | | |
| 22 | | | | | |

NATIONAL GOVERNMENT CONSTITUENCIES
DEVELOPMENT FUND BOARD

17 JUN 2022

CORPORATE SOCIAL RESPONSIBILITY
PROGRAMME

| ITEM NO | DESCRIPTION | QTY | UNIT | RATE | SHS |
|---|---|------|------|------|---------|
| | <u>PRIME COST AND PROVISIONAL SUMS</u> <u>EXPENDITURE FOR ITEMS HERE BELOW SHALL BE APPROVED BY NG-CDF BOARD</u> <u>The following sums shall be expended upon Architect's instructions and may be omitted in whole:</u> | | | | |
| A | Allow for a Provisional Sum of Kenya Shillings One Hundred Thousand (Kshs.100,000/) for Contingency | ITEM | | SUM | 100,000 |
| B | Allow for a Prime Cost Sum of Kenya Shillings Fifty Thousand (Kshs.50,000/) for Supply and Delivery of 9KG and 2NO. Water base and 9 Litre X2NO. Carbon dioxide Fire extinguishers mounted on walling to approval | ITEM | | SUM | 50,000 |
| C | Allow for Branding of Project in accordance with NG-CDF Board Specifications | ITEM | | SUM | 15,000 |
| | <u>FURNITURE</u> | | | | |
| D | Allow for a Provisional Sum of Kenya Shillings (Kshs 286,000.00) for Fabrication and Supply of 68NO Ordinary Desk for 2NO. Pupils ,3NO.Teachers' and 3NO.Chairs to be supplied by an approved Supplier with specifications from County Works Officer and Head Teacher | ITEM | | SUM | 286,000 |
| E | Allow for Transport to site | ITEM | | 10% | 28,600 |
| TOTAL FOR PRIME COST AND PROVISIONAL SUMS CARRIED TO MAIN SUMMARY | | | | | |

23

NATIONAL GOVERNMENT CONSTITUENCIES
DEVELOPMENT FUND BOARD
17 JUN 2022
CORPORATE SOCIAL RESPONSIBILITY
PROGRAMME

NATIONAL GOVERNMENT CONSTITUENCIES
DEVELOPMENT FUND BOARD
17 JUN 2022
CORPORATE SOCIAL RESPONSIBILITY
PROGRAMME

| ITEM NO | DESCRIPTION | SHS |
|--|------------------------------------|-----|
| PROPOSED CONSTRUCTION OF 3NO.CLASSROOMS | | |
| <u>MAIN SUMMARY</u> | | |
| A | SUBSTRUCTURE | |
| B | REINFORCED CONCRETE SUPERSTRUCTURE | |
| C | WALLING | |
| D | ROOFING | |
| E | DOORS | |
| F | WINDOWS | |
| G | FINISHES | |
| H | FIXTURES | |
| I | WATER TANK | |
| J | ELECTRICAL INSTALLATION | |
| K | PRIME COST AND PROVISIONAL SUMS | |
| L | PRELIMINARIES | |
| SUB-TOTAL | | |
| ADD VAT 16% | | |
| TOTAL COST OF 3NO.CLASSROOMS CARRIED TO | | |
| FORM OF TENDER | | |
| <div data-bbox="175 1892 638 2027" style="border: 1px solid black; padding: 2px;"> NATIONAL GOVERNMENT CONSTITUENCIES DEVELOPMENT FUND BOARD </div> | | |
| | | |
| | | |
| | | |
| | | |
| | | |
| | | |
| | | |
| | | |
| 24 | | |

17 JUN 2022

CORPOR.

JF

NATIONAL GOVERNMENT CONSTITUENCIES
DEVELOPMENT FUND BOARD

17 JUN 2022

CORP

PROGRAM

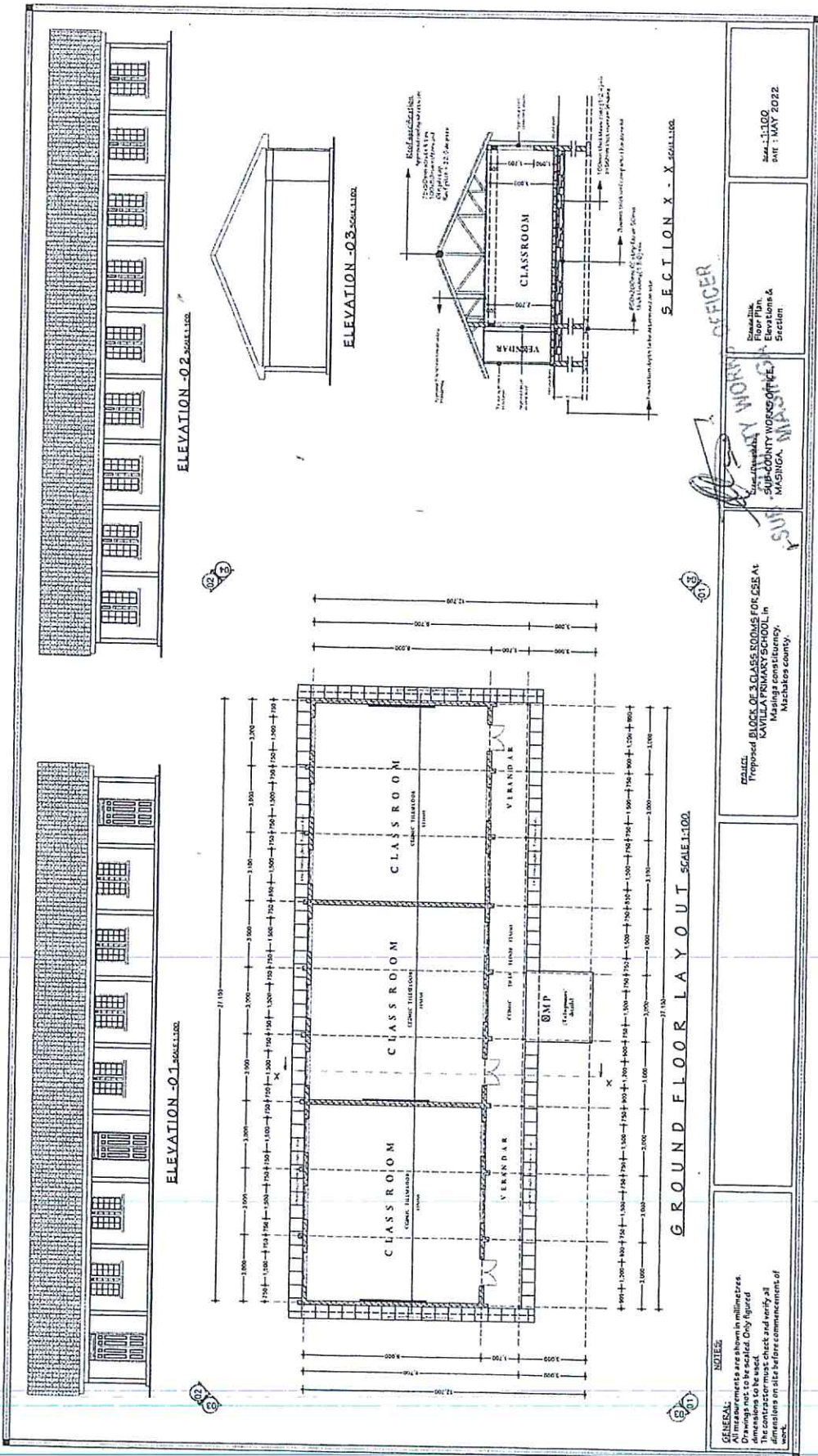

GENERAL NOTES:
 All measurements are shown in millimetres.
 Dimensions are to be checked.
 The contractor must check and verify all dimensions on site before commencement of work.

CALL:
 Proposed BLOCK OF 3 CLASS ROOMS FOR CBS AT
 KAVILLA PRIMARY SCHOOL, in
 the village of Kavilla, in
 MASHINGA, MASINGA, MALAWI.

DESIGNED BY:
 SUB-COUNTY WORKS OFFICE
 MASHINGA, MALAWI

SCALE: 1:100
DATE: 17 MAY 2022

SECTION X - X SCALE 1:100

GROUND FLOOR LAYOUT SCALE 1:100

NATIONAL GOVERNMENT CONSTRUCTION PROGRAMME
 17 JUN 2022
 CORPORATE SOCIAL RESPONSIBILITY

