

REPUBLIC OF KENYA



**NAROK EAST NATIONAL GOVERNMENT  
CONSTITUENCY DEVELOPMENT FUND**

**BILLS OF QUANTITIES FOR PROPOSED  
CONSTRUCTION TO COMPLETION OF  
8NO. DOORS PIT LATRINE BLOCK**

**AT**

**OLOSIRO PRIMARY SCHOOL**

**TENDER DOCUMENT**

**FINANCIER: NAROK EAST NG-CDF FY 2024/2025**

**TENDER NO...NE/NG-CDF/T/08/2024/2025**

**ISSUED BY:**

REGIONAL WORKS OFFICE  
STATE DEPARTMENT FOR PUBLIC WORKS  
P.O. BOX 660,  
NAKURU

**APRIL, 2025**

## **INSTRUCTION TO BIDDERS**

### **1. COST OF ITEMS OF PRELIMINARIES.**

The Tenderer shall be deemed to have included in his rates for the various items in the measured bills of quantities for all costs involved in complying with the requirements of preliminaries for the proper execution of the works in the contract.

### **2. ELEGIBLE BIDDERS**

The bidder must meet the following requirements.

<b>ITEM</b>	<b>MANDATORY REQUIREMENT (MR) – MAIN CONTRACTOR</b>
MR1	Certificate of Incorporation / Registration from the Registrar of Companies / Businesses;
MR2	A copy of company's list of directors, beneficial owners, name if proprietor or names of partners (copy of CR 12) for the bidder not more than one year old
MR3	Current Category of Registration with National Construction Authority (NCA) in the relevant trade; NCA 8 and above
MR4	Contractor's Annual Practicing License from NCA for the current year
MR5	Valid Tax Compliance Certificates;
MR6	Dully filled Form of Disclosure
MR 7	Confidential business questionnaire
MR8	Dully Filled Self Declaration Form
MR9	Proof of Similar Works Previously done in the last two (2) years
MR10	Proof of Financial capacity 9(Audited accounts for last two (2) years
MR11	Form of Quotation Fully Filled & Signed
MR12	Business physical location proof/Business permit

### **3. SITE VISIT**

The bidder is advised to visit and examine the site of work and obtain for himself all information necessary for construction works. The cost of visiting the site shall be at the bidders own expense.

### **4. BID VALIDITY.**

The bid rates shall remain valid for a period of 150days after the date of opening.

### **5. FIRM PRICE CONTRACT.**

This is a firm price contract and the contractor must allow in his tender for any increase in the cost of labour and materials within the contract period.

### **6. CLIENT'S RIGHT.**

The client reserve the right to accept or reject any bid and to annual the bidding process and reject all bids any time prior to award of the contract without thereby incurring any liability to the affected bidder or bidders or any obligations to inform the affected bidders of the grounds for the client's action.



9. We, along with any of our subcontractors, suppliers, Engineer, manufacturers, or service providers for any part of the contract, are not subject to, and not controlled by any entity or individual that is subject to a temporary suspension or a debarment imposed by the Public Procurement Regulatory Authority or any other entity of the Government of Kenya, or any international organization.
10. We hereby certify that we have taken steps to ensure that no person acting for us or on our behalf engages in any type of Fraud and Corruption.
11. We hereby certify and confirm that the Quotation is genuine, non-collusive and made with the intention of accepting the contract if awarded. To this effect we have signed the "Certificate of Independent Quotation Determination" attached below.
12. We, the Tenderer, have completed fully and signed the **FORM FOR DISCLOSURE OF INTEREST**- interest of the firm in the Procuring Entity, attached below.

The Delivery/Completion period offered is: \_\_\_\_\_ days from date of acceptance of Quotation. The warranty period offered is \_\_\_\_\_ weeks.

Quotation Authorized by:

Name and designation \_\_\_\_\_ Signature: \_\_\_\_\_

## i) SCHEDULE OF REQUIREMENTS TABLE

(Procuring Entity will complete the list of items to be same as those on Part 2 Table A. Schedule of Requirements and Technical Specifications and tenderer should complete columns D and E).

<b>A</b> Item	<b>B</b> Description of Goods/works/services (Procuring Entity to select one)	<b>C</b> Quantity	<b>D</b> Unit price	<b>E</b> Total Price in Ksh
1.	SEE ATTACHED BILL OF QUANTITIES			
2.				
3.				
4.				
5.				
<b>TOTAL PRICE IN KSH.</b>				

Signature: \_\_\_\_\_

And seal/Stamp

Name:

Position:

Authorized for and on behalf of (specify name of tenderer) \_\_\_\_\_

Date \_\_\_\_\_

ii) **TENDERER'S ELIGIBILITY - CONFIDENTIAL BUSINESS QUESTIONNAIRE**

**Instruction to Tenderer**

Tender is instructed to complete the particulars required in this Form, *one form for each entity if Tender is a JV*. Tenderer is further reminded that it is an offence to give false information on this Form.

(a) **Tenderer's details**

	<b>ITEM</b>	<b>DESCRIPTION</b>
1	Name of the Procuring Entity	
2	Reference Number of the Tender	
3	Date and Time of Tender Opening	
4	Name of the Tenderer	
5	Full Address and Contact Details of the Tenderer.	1. Country 2. City 3. Location 4. Building 5. Floor 6. Postal Address 7. Name and email of contact person.
6	Current Trade License Registration Number and Expiring date	
7	Name, country and full address ( <i>postal and physical addresses, email, and telephone number</i> ) of Registering Body/Agency	
8	Description of Nature of Business	
9	Maximum value of business which the Tenderer handles.	
10	State if Tenders Company is listed in stock exchange, give name and full address ( <i>postal and physical addresses, email, and telephone number</i> ) of state which stock exchange	

**General and Specific Details**

b) **Sole Proprietor**, provide the following details.

Name in full \_\_\_\_\_ Age \_\_\_\_\_ Nationality \_\_\_\_\_  
 \_\_\_\_\_ Country of Origin \_\_\_\_\_ Citizenship \_\_\_\_\_  
 \_\_\_\_\_

c) **Partnership**, provide the following details.

	Names of Partners	Nationality	Citizenship	% Shares owned
1				
2				
3				

d) **Registered Company**, provide the following details.

i) Private or public Company \_\_\_\_\_

ii) State the nominal and issued capital of the Company \_\_\_\_\_ Nominal  
 Kenya Shillings (Equivalent)..... Issued Kenya Shillings  
 (Equivalent).....

iii) Give details of Directors as follows.

	Names of Director	Nationality	Citizenship	% Shares owned
1				
2				
3				

iii) **FORM FOR DISCLOSURE OF INTEREST** - Interest of the Firm in the Procuring Entity.

i) Are there any person/persons in ..... (Name of Procuring Entity) who has/have an interest or relationship in this firm? Yes/No.....

If yes, provide details as follows.

	Names of Person	Designation in the Procuring Entity	Interest or Relationship with Tenderer
1			
2			
3			

ii) Conflict of interest disclosure

		<b>Disclosure YES OR NO</b>	<b>If YES provide details of the relationship with Tenderer</b>
1	Tenderer is directly or indirectly controls, is controlled by or is under common control with another tenderer.		
2	Tenderer receives or has received any direct or indirect subsidy from another tenderer.		
3	Tenderer has the same legal representative as another tenderer		
4	Quotation has a relationship with another tenderer, directly or through common third parties, that puts it in a position to influence the quotation of another tenderer, or influence the decisions of the Procuring Entity regarding this quotation process.		
5	Any of the Tenderer's affiliates participated as a consultant in the preparation of the design or technical specifications of the works that are the subject of the quotation.		
6	Tenderer would be providing goods, works, non-consulting services or consulting services during implementation of the contract specified in this Quotation Document.		
7	Tenderer has a close business or family relationship with a professional staff of the Procuring Entity who are directly or indirectly involved in the preparation of the Quotation document or specifications of the Contract, and/or the Quotation evaluation process of such contract.		
8	Tenderer has a close business or family relationship with a professional staff of the Procuring Entity who would be involved in the implementation or supervision of the such Contract.		
9	Has the conflict stemming from such relationship stated in item 7 and 8 above been resolved in a manner acceptable to the Procuring Entity throughout the quotation process and execution of the Contract.		

**iii) Certification**

On behalf of the Tenderer, I certify that the information given above is complete, current and accurate as at the date of submission.

Full Name \_\_\_\_\_

Title or Designation \_\_\_\_\_

\_\_\_\_\_  
*(Signature)*

\_\_\_\_\_)\_\_\_\_\_  
*(Date)*

# iv) CERTIFICATE OF INDEPENDENT QUOTATION DETERMINATION

I, the undersigned, in submitting the accompanying Letter of quotation to the \_\_\_\_\_  
\_\_\_\_\_ *[Name of Procuring Entity]* for: \_\_\_\_\_  
\_\_\_\_\_ *[Name and number of quotation]* in response to the request for  
tenders made by: \_\_\_\_\_ *[Name of Tenderer]* do hereby make the following  
statements that I certify to be true and complete in every respect:

I certify, on behalf of \_\_\_\_\_ *[Name of Tenderer]* that:

1. I have read and I understand the contents of this Certificate;
2. I understand that the Tenderer will be disqualified if this Certificate is found not to be true and complete in every respect;
3. I am the authorized representative of the Tenderer with authority to sign this Certificate, and to submit the quotation on behalf of the Tenderer;
4. For the purposes of this Certificate and the quotation, I understand that the word "competitor" shall include any individual or organization, other than the Tenderer, whether or not affiliated with the Tenderer, who:
  - a) has been requested to submit a quotation in response to this request for quotations;
  - b) could potentially submit a quotation in response to this request for quotations based on their qualifications, abilities or experience;
5. The Tenderer discloses that [check one of the following, as applicable]:
  - a) The Tenderer has arrived at the quotation independently from, and without consultation, communication, agreement or arrangement with, any competitor;
  - b) the Tenderer has entered into consultations, communications, agreements or arrangements with one or more competitors regarding this request for quotations, and the Tenderer discloses, in the attached document(s), complete details thereof, including the names of the competitors and the nature of, and reasons for, such consultations, communications, agreements or arrangements;
6. In particular, without limiting the generality of paragraphs (5)(a) or (5)(b) above, there has been no consultation, communication, agreement or arrangement with any competitor regarding:
  - a) prices;
  - b) methods, factors or formulas used to calculate prices;
  - c) the intention or decision to submit, or not to submit, a quotation; or
  - d) the submission of a quotation which does not meet the specifications of the request for quotations; except as specifically disclosed pursuant to paragraph (5) (b) above;
7. In addition, there has been no consultation, communication, agreement or arrangement with any competitor regarding the quality, quantity, specifications or delivery particulars of the works or services to which this request for tenders relates, except as specifically authorized by the procuring authority or as specifically disclosed pursuant to paragraph (5)(b) above;
8. the terms of the quotation have not been, and will not be, knowingly disclosed by the Tenderer, directly or indirectly, to any competitor, prior to the date and time of the official quotation opening, or of the awarding of the Contract, whichever comes first, unless otherwise required by law or as specifically disclosed pursuant to paragraph (5)(b) above.

Name \_\_\_\_\_

Title \_\_\_\_\_

Date \_\_\_\_\_

*[Name, title and signature of authorized agent of Tenderer and Date]*

# v) SELF-DECLARATION FORM

We, the Tenderer \_\_\_\_\_ (*insert name*) submitting our Quotation in respect of Quotation No \_\_\_\_\_ for \_\_\_\_\_ (*insert quotation Title Description*) for \_\_\_\_\_ (*insert Name of Procuring Entity*)

## DECLARE AS FOLLOWS:

That, We the Tenderer including any entity or individual that directly or indirectly controls, is controlled by or is under common control with us, and any subcontractors, suppliers, project managers, consultants, manufacturers, service providers, agents, individuals, or any other party involved or to be involved for any part of the processes of procurement and contract execution related to the above quotation:

- a) have not engaged/will not engage in any corrupt or fraudulent practices in the processes of procurement and contract execution related to the above quotation as defined and/or described in the following:
  - i) the RFQ for the above Quotation;
  - ii) Kenya's Public Procurement and Asset Disposal Act, 2015) and its attendant Regulations;
  - iii) Kenya's Anti-Corruption and Economic Crimes Act, 2013; and
  - iv) any such other Acts or Regulations of Government of Kenya;
- b) have not offered/will not offer any inducement to any member of the board, management, staff and/or employees and/or agents of ..... (*name of the procuring entity*);
- c) have not engaged/will not engage in any collusive or corrosive practice with other tenderers participating in the subject quotation;
- d) have not been sanctioned or debarred by any entity from participation in public procurement proceedings of Kenya.

That, what is deponed to herein above is true to the best of our knowledge, information and belief.

**Name of the Tenderer:** ..... [*insert complete name of tenderer signing the quotation*]

**Name of the person duly authorized to sign the quotation on behalf of the Tenderer:**  
..... [*insert complete name of person duly authorized to sign the quotation*]

**Title of the person signing the Quotation:** ..... [*insert complete title of the person signing the quotation*]

**Signature of the person named above:** ..... [*insert signature of person whose name and capacity are shown above*]

## vi) FOREIGN TENDERER 40% RULE

*(not to be included in the RFQ for supply of goods, supply and installation of plant and equipment, insurance, purchase of property, and other RFQ where this rule may not be practical).*

Pursuant to the provisions in the Public Procurement and Disposal Act, 2015, a Foreign Tenderer must complete this form to demonstrate that the quotation fulfils this condition.

ITEM	Description of Work Item	Describe location of Source	COST in K. shillings	Comments, if any
A	Local Labor			
1				
2				
3				
4				
5				
6				
B				
1				
2				
3				
4				
5				
C	Local materials			
1				
2				
3				
4				
5				
D				
1				
2				
3				
4				
5				
E				
1				
2				
3				
4				
5				
6				
	TOTAL COST LOCAL CONTENT		XXXXX	

## PART 2: SCHEDULE OF REQUIREMENTS

TABLE A. SCHEDULE OF REQUIREMENTS, TECHNICAL SPECIFICATIONS

Table A. SCHEDULE OF REQUIREMENTS AND TECHNICAL SPECIFICATIONS

*[Procuring Entity to complete Columns a-d and Tenderer to complete Column Indicating YES or No and if NO indicate the specification of the offered item]*

Item No	Description of Goods/works/service <i>(Procuring Entity to select one)</i> <i>For Works attach drawings</i>	Quantity	TECHNICAL SPECIFICATIONS (completed by <i>Procuring Entity</i> )	CONFORMITY WITH TECHNICAL SPECIFICATIONS <i>(to be completed by Tenderer)</i>
1A	B	C	D	E
2	<b>SEE ATTACHED BILL OF QUANTITIES</b>			
3				
4				
5				
6.				
7				
8				
9				

ATTACHMENTS *(to be listed below and supplied by Procuring Entity)*

ETC.

## **TECHNICAL SPECIFICATIONS FOR WORKS/SERVICES**

- a) A preliminary description of the proposed works/services and work method and schedule, including drawings and charts, as necessary, containing all required information by which the proposed works may be evaluated (e.g. technical characteristics, operational capacities, maintenance, environmental effect, etc.) together with manuals or instructions for use or any other relevant information and documentation, delivery/installation schedules, etc.;
- b) A detailed statement of how the tenderer will carry out the works/services that will form an integral part of the Contract.
- c) **DRAWINGS**

*(Procuring Entity to attach Drawings (if any))*

(Procuring Entity will complete the list of items to be same as those on Table A. Schedule of Requirements and Technical Specifications and tenderer should complete columns c-e)

Item	Description of Goods/works/services (Procuring Entity to select one)	Quantity	Unit price	Total Price
1	SEE ATTACHED BILL OF QUANTITIES			
2				
3				
4				
5				
6				
7				
8				
9				
		TOTAL PRICE		

Signature: \_\_\_\_\_

And seal/Stamp \_\_\_\_\_

Name: \_\_\_\_\_

Position:

Authorised for and on behalf of (specify name of tenderer) \_\_\_\_\_

Date \_\_\_\_\_

# **AGREEMENT FORM**

(1) THIS CONTRACT AGREEMENT is made \_\_\_\_\_ (specify date).  
Between ..... [Insert complete name of Procuring Entity],  
and having its principal place of Business at ..... [Insert address of  
Procuring Entity] and SUPPLIER

\_\_\_\_\_  
[Insert name of Supplier, or contractor or service provider], and having its  
principal place of business at \_\_\_\_\_  
..... [ins  
ert address of Supplier, contractor or service provider].

(2) WHEREAS the Procuring Entity invited quotations for the Supply of Goods/works/services  
(select one) described in Table B, i.e. .... (.  
**insert name of the project**) and has accepted a Quotation by the Tenderer in the sum of  
..... [insert Contract Price in words and figures] (hereinafter called “the  
Contract Price”).

(3) NOW THIS AGREEMENT WITNESSED AS FOLLOWS:

1. This Contract Agreement includes the following documents:

- a) Table A. SCHEDULE OF REQUIREMENTS AND TECHNICAL SPECIFICATIONS.
- b) Table B. QUOTATION SUBMISSION TABLE.
- c) FORM OF QUOTATION.
- d) Conditions of Contract.

2. In consideration of the payments to be made by the Procuring Entity to the **Supplier** as  
hereinafter mentioned, the *Supplier/contractor/service provider* hereby covenants with  
the Procuring Entity to provide the Goods/works/services and to remedy defects  
therein in conformity in all respects with the provisions of the Contract.

3. The Procuring Entity hereby covenants to pay the **Supplier** in consideration of the  
provision of the **Goods** and the remedying of defects therein, the Contract Price or such  
other sum as may become payable under the provisions of the Contract at the times and in  
the manner prescribed by the Contract.

(4) In WITNESS whereof the parties hereto have caused this Agreement to be executed in  
accordance with the laws of Kenya.

**For and on behalf of the Procuring Entity-NG-CDF NAROK EAST**

Signed: ..... [insert signature]

in the capacity of..... [Insert Title -]  
NAME

in the presence of..... [witness]

**For and on behalf of the Supplier**

Signed: ..... *[insert signature of authorized representative(s) of the Supplier]*

in the capacity of..... *[DIRECTOR]*

*NAME*

in the presence of..... *[insert identification of official witness]*

## SPECIAL CONDITIONS OF CONTRACT

<b>A. General</b>	
<b>GCC 1.1 (r)</b>	The Procuring Entity is: <b>NG-CDF NAROK EAST, P.O Box 660-20500 Narok,</b>
<b>GCC 1.1 (s)</b>	The Intended Completion date for the whole of the works shall be; <b>4 Months form the date of contract signing</b>
<b>GCC 1.1 (t)</b>	The Project Manager is: Regional Works Officer. State Department of Public Works, P.O Box 660 – 20100, Nakuru Telephone: Facsimile: Email:
<b>GCC 1.1 (aa)</b>	<b>The site is located at OLOSIRO PRIMARY SCHOOL</b>
<b>GCC 1.1 (dd)</b>	The Start date shall be <b>agreed with the Project Manager but not later than 7 days after signing of the contract/handing over of site- whichever comes first.</b>
<b>GCC 1.1 (hh)</b>	The Works consist of: <b>Proposed Construction of 8doors girls pit latrines</b>
<b>GCC 2.2</b>	Sectional Completions are <b>Not Applicable</b>
<b>GCC 5.1</b>	<b>The Project Manager may delegate any of his duties and responsibilities</b>
<b>GCC 8.1</b>	Schedule of Contractors: <b>Not Applicable</b>
<b>GCC 9.1</b>	<p><b>Key Personnel</b></p> <p>GCC 9.1 is replaced with the following:</p> <p>9.1 Key Personnel are the Contractor’s personnel named in this GCC 9.1 Special Conditions of Contract. The Contractor shall employ the Key Personnel and use the equipment identified in its Bid, to carry out the Works or other personnel and equipment approved by the Project Manager. The Project Manager shall approve any proposed replacement of Key Personnel and equipment only if their relevant qualifications or characteristics are substantially equal to or better than those proposed in the Bid.</p> <p>[insert the name/s of each Key Personnel agreed by the Procuring Entity prior to Contract signature.]</p>
<b>GCC 13.1</b>	<p>The minimum insurance amounts and deductibles shall be: <b>Contractor’s all risk Policy</b></p> <p>(a) for loss or damage to the Works, Plant and Materials:</p> <p>(b) For loss or damage to Equipment:</p> <p>(c) for loss or damage to property (except the Works, Plant, Materials, and Equipment) in connection with Contract: <b>Contractor’s all risk Policy</b></p> <p>(d) for personal injury or death:</p> <p>(i) of the Contractor’s employees: <b>Contractor’s all risk Policy</b></p>

	of other people: <b>Contractor's all risk Policy</b>
<b>GCC 14.1</b>	Site Data are: <b>Not Applicable</b>
<b>GCC 16</b>	Completion Time: <b>12 weeks</b>
<b>GCC 20.1</b>	The Site Possession Date(s) shall be: <b>To be agreed with Project Manager</b>
<b>GCC 23.1 &amp; GCC 23.2</b>	Appointing Authority for the Adjudicator: <b>Chartered Institute of Arbitrators (CI Arb) Kenyan Chapter, AAK, or IQSK</b>
<b>GCC 24.3</b>	Hourly rate and types of reimbursable expenses to be paid to the Adjudicator: <b>As per the standard fees of the proposed bodies above of the Appointing Authority.</b>

#### **I B. Time Control**

<b>GCC 26.1</b>	The Contractor shall submit for approval a Program for the Works within <b>Fourteen (14)</b> days from the date of the Letter of Acceptance.
<b>GCC 26.3</b>	The period between Program updates is <b>Thirty (30)</b> days. The amount to be withheld for late submission of an updated Program is <b>Not Applicable.</b>

#### **I C. Quality Control**

<b>GCC 34.1</b>	The Defects Liability Period is: <b>180 days.</b>
-----------------	---

#### **I D. Cost Control**

<b>GCC 38.7</b>	If the value engineering proposal is approved by the Procuring Entity the amount to be paid to the Contractor shall be; <b>Not Applicable</b>
<b>GCC 44.1</b>	The currency of the Procuring Entity's Country is: <b>Kenya Shillings</b>
<b>GCC 45.1</b>	The Contract <b>is not</b> subject to price adjustment in accordance with GCC Clause 45, and the following information regarding coefficients <b>does not</b> apply.  The coefficients for adjustment of prices are: (a) 0% percent nonadjustable element (coefficient A). (b) 0% percent adjustable element (coefficient B). (c) The Index I for shall be: <b>Not Applicable.</b>
<b>GCC 46.1</b>	The proportion of payments retained is: <b>5%</b>
<b>GCC 47.1</b>	The liquidated damages for the whole of the Works are <b>0.05%</b> per day. The maximum amount of liquidated damages for the whole of the Works is <b>5%</b> of the final Contract Price.
<b>GCC 49.1</b>	The Advance Payments shall be: <b>Not Applicable</b> and shall be paid to the Contractor no later than <b>Not Applicable.</b>

#### **I E. Finishing the Contract**

<p><b>GCC 56.1</b></p>	<p>The date by which operating and maintenance manuals are required is: <b>On practical completion date</b></p> <p>The date by which "as built" drawings are required is: <b>On practical completion date</b></p>
<p><b>GCC 56.2</b></p>	<p>The amount to be withheld for failing to produce "as built" drawings and/or operating and maintenance manuals by the date required in GCC 58.1 is: <b>The Retention money.</b></p>
<p><b>GCC 57.2 (g)</b></p>	<p>The maximum number of days is: <b>One Hundred Twenty (120) Days.</b></p>
<p><b>GCC 58.1</b></p>	<p>The percentage to apply to the value of the work not completed, representing the Procuring Entity's additional cost for completing the Works, is <b>Five (5) %</b></p>

ITEM	DESCRIPTION	QTY	UNIT	RATE	KSHS
	<b><u>PROPOSED GIRLS PIT LATRINE BLOCK</u></b> <b><u>8No. DOORS BLOCK</u></b>				
	<b><u>ELEMENT NO. 1</u></b>				
	<b><u>SUBSTRUCTURES (ALL PROVISIONAL)</u></b>				
	<b><u>Site clearance</u></b>				
A	Clear the site off grass, shrubs and all vegetation; cart away as directed	30	Sm		
B	Excavate vegetable soil average 200mm deep and cart away as directed	30	Sm		
	<b><u>Excavation</u></b>				
C	Excavate oversite to reduce levels commencing from stripped level average 300mm deep and spread on site av.10 meters away.	5	Cm		
D	Excavate for strip foundation starting from reduced level not exceeding 1.50 meters deep and cart away as directed	19	Cm		
E	Ditto; 1.50-3.00 meter deep	6	Cm		
F	Ditto; 3.00-4.50 meter deep	20	Cm		
G	Extra over excavation for excavating in rock.	3	Cm		
H	Return fill-in and rum selected excavated material	18	Cm		
I	Remove and cart away from site surplus excavated material as directed	6	Cm		
	<b><u>Disposal of water</u></b>				
J	Keeping all excavations free from all water including spring or running water		Item		
	<b><u>Planking and strutting</u></b>				
K	Uphold the sides of ail excavations		Item		
	<b>Carried to collection</b>				

ITEM	DESCRIPTION	QTY	UNIT	RATE	KSHS
	<b><u>Filling</u></b>				
A	Hardcore filling in making up levels exceeding 300mm thick, depositing and compacting in layers of 150mm maximum thickness	10	Sm		
B	50mm thick murrain blinding to surfaces of fill	10	Sm		
	<b><u>Ant termite treatment</u></b>				
C	TERMEDOR' or other equal and approved insecticide with a ten-years guarantee to surfaces of fill and tops of foundations	28	Sm		
	<b><u>Concrete</u></b>				
D	50mm thick mass concrete class Q (1:3:6) to bottoms of foundations	16	Sm		
	<b><u>In situ concrete; reinforced; class 20 / (20mm); vibrated</u></b>				
E	Foundations in trenches irrespective of thickness	2	Cm		
F	150mm thick bed	28	Sm		
G	Ramps	0.5	Cm		
	<b><u>Reinforcement</u></b>				
	<b><u>Bars; high yield steel; cold worked to B.S. 4461 including bends, hooks, tying wire and distance blocks</u></b>				
H	12mm bars	196	Kg		
I	10mm bars	55	Kg		
J	8mm bars	35	Kg		
<b>Carried to collection</b>					

ITEM	DESCRIPTION	QTY	UNIT	RATE	KSHS
	<u>Fabric: B.S. 4483</u>				
A	Reference A98 mesh 200 x 200 mm , weight 2.22 kgs per square meter (measured net - no allowance made for laps( including bends, tying wire and distance blocks	28	Sm		
	<b><u>Sawn formwork to insitu concrete as described:-</u></b>				
B	To sides; vertical or battering of strip foundations.	2	Sm		
C	Soffits of suspended pit latrine slab including 100mm dia. Pos	20	Sm		
D	Edges of ground floor slab; 75 to 150mm wide	22	Lm		
	<b><u>Walling</u></b>				
F	200mm thick approved local natural stone; roughly squared to foundation walling; bedding and jointing in cement sand (1:3) mortar	32	Sm		
	<b><u>Damp proofing</u></b>				
G	Polythene; 1000 gauge, 150mm laps (no allowance made l to laps), horizontal; 1 no. layer laid on murrum blinding	28	Sm		
H	150mm wide; B.S. 743 Type A bitumen hessian base 150 nun laps (no allowance made for laps); horizontal, 1 no. layer, bedded in cement sand (1:3) mortar	36	Lm		
	<b><u>Insitu finishings</u></b>				
J	14mm thick 2 No. coat work cement sand (1:3) render; wood floated to concrete or blockwork base to walls; external	6	Sm		
	<u>Prepare and apply three coats black bituminous paint on:-</u>				
K	Rendered plinths, externally.	6	Sm		
<b>Carried to collection</b>					

ITEM	DESCRIPTION	QTY	UNIT	RATE	KSHS
	<p><b>COLLECTION</b></p> <p>A From page PL/1</p> <p>B From page PL/2</p> <p>C From page PL/3</p>				
<p><b>TOTAL FOR SUBSTRUCTURES CARRIED TO SUMMARY</b></p>					

ITEM	DESCRIPTION	QTY	UNIT	RATE	KSHS
	<b><u>ELEMENT NO. 2</u></b>				
	<b><u>RINGBEAM</u></b>				
	<u>Insitu concrete: reinforced: class 20 / (20mm): vibrated</u>				
A	Beams	0.6	Cm		
	<u>Reinforcement</u>				
	<u>Bars; high yield steel; cold worked to B.S. 4461 including ends, hooks, tying wire and distance blocks</u>				
B	12mm bars	69	Kg		
C	8mm bars	28	Kg		
	<u>Sawn formwork to insitu concrete as described:-</u>				
D	To sides and soffits of beams	8	Sm		
E	100mm heavy duty grey pipe class D.	5	Lm		
F	vent and crowl	2	No		
<b>TOTAL FOR FRAME CARRIED TO SUMMARY</b>					

ITEM	DESCRIPTION	QTY	UNIT	RATE	KSHS
	<b><u>ELEMENT NO. 3</u></b>				
	<b><u>EXTERNAL &amp; INTERNAL WALLING</u></b>				
	<b><u>NATURAL STONE WALLING</u></b>				
A	150 mm thick approved local; medium dressed; bedding, jointing and pointing in cement sand (1:3) mortar externally	36	Sm		
B	150 mm thick approved local; medium dressed; bedding, jointing and pointing in cement sand (1:3) mortar internally	32	Sm		
C	250x50mm weathered and throated pre cast concrete coping stones bedded and jointed to walls in cement sand (1:3) mortar	12	Lm		
<b>TOTAL FOR EXTERNAL &amp; INTERNAL WALLING CARRIED TO SUMMARY</b>					

ITEM	DESCRIPTION	QTY	UNIT	RATE	KSHS
	<b><u>ELEMENT N0.4</u></b>				
	<b><u>ROOFING</u></b>				
	<b><u>Galvanized corrugated Sheet roofing; 30 gauge: Pre-painted</u></b>				
A	Roof covering not exceeding 45° from horizontal; fixing to timber structure (m/s) with rubber washers to match.	19	Sm		
B	Ditto to ridge cap	5	Lm		
	<b><u>CARPENTRY</u></b>				
	<u>The following in sawn celcured cypress</u>				
C	100 x 50mm rafters	20	Lm		
D	100x50mm king post	5	Lm		
E	100x50mm thick tie beam	20	Lm		
F	100 x 50mm wall plate rag-bolted at 1200mm centres with 12mm diameter bolts (m/s)	10	Lm		
G	75 x 50mm sawn cypress purlins	29	Lm		
H	75x50mm struts and tie	22	Lm		
	Fascia				
I	200 x 25mm thick fascia board	18	Lm		
J	Knot, prime, stop and apply 3 coats super gloss oil paint to surfaces of fascia and vergeboard 200-300mm high.	18	Lm		
<b>TOTAL FOR ROOF CARRIED TO SUMMARY</b>					

ITEM	DESCRIPTION	QTY	UNIT	RATE	KSHS
	<b><u>ELEMENT NO. 5</u></b>				
	<b><u>OPENINGS</u></b>				
	<b><u>Wrot celcured cypress framed and framings</u></b>				
A	100 x 50mm; 2 No. labours; plugged door frame	40	Lm		
B	40 x 25mm weathered architrave	40	Lm		
C	25mm rounded quardrant	40	Lm		
	<b><u>55mm thick Framed ledged and braced match boarded door comprising 125x50mm top rail and stiles,200x50mm bottom rail,150x25mm tongued and grooved boarding vee jointed on ne side and 6mm thick plywood panel on the other side</u></b>				
D	Door size 900 x 2100 mm high	8	No.		
	<b><u>Iron mongery</u></b>				
	<b><u>Supply and fix the following to UNION catalogue or other equal and approved</u></b>				
	To softwood, .hardwood or the like fixing with screws				
E	150 mm locking bolt	8	No		
F	Bronze D-shape pull handles	8	No		
G	100mm steel butt hinges	12	Prs		
	<b><u>Painting and Decorations</u></b>				
	<b><u>Prepare and apply three coats oil paint full gloss to Crown Solo- or other equal and approved to; -</u></b>				
H	General surfaces of doors; over 300mm girth internal	16	Sm		
I	Ditto externally	16	Sm		
	Carried to collection				

ITEM	DESCRIPTION	QTY	UNIT	RATE	KSHS
A	<u>Aluminium primer or other equal and approved wood primer before fixing:-</u> Backs of frame, board, etc over 100mm but not exceeding 200mm girth	40	Lm		
B	<u>Prepare and apply three coats oil paint full gloss to Crown Solo or other equal and approved to: -</u> Timber Frames; over 100mm but not exceeding 200mm girth	40	Lm		
	<b>Carried to collection</b>  <u>COLLECTION</u> From page PL/8  From above				
<b>TOTAL FOR OPENNINGS CARRIED TO SUMMARY</b>					

ITEM	DESCRIPTION	QTY	UNIT	RATE	KSHS
	<b><u>ELEMENT NO.6</u></b>				
	<b><u>FINISHES</u></b>				
	<b><u>Wall finishes</u></b>				
	<b><u>Plaster; 12mm thick 2 No. coatwork, 9mm first coat of cement sand (1:6); 3mm second coat of cement and lime putty fl: 10); steel trowelled to concrete or blockwork base generally to: -</u></b>				
A	Walls; internal	102	Sm		
B	Extra over horizontal pointing in 10mm thick rod in cement and sand (1:3) mortar to external wall	34	Sm		
C	Plastered walls and beams	6	Sm		
	<b><u>In situ Finishings</u></b>				
	<b><u>Screed; 40mm thick water-proof cement sand (1:3); red-oxide coloured: steel trowelled to concrete or blockwork base generally to:</u></b>				
D	Floors; internal	24	Sm		
E	Skirtings; 100mm wide with rounded junction with wall finish and coved junction with floor finish	46	Lm		
	<b><u>Prepare and apply three coats oil paint full gloss to Crown Solo or other equal and approved to: -</u></b>				
F	Plastered surfaces generally over 100mm but not exceeding 200mm girth	102	sm		
G	Ditto externally	6	Sm		
<b>TOTAL FOR FINISHES CARRIED TO SUMMARY</b>					

ITEM	DESCRIPTION	QTY	UNIT	RATE	KSHS
A	SUBSTRUCTURE (ALL PROVISIONAL)				
B	RING BEAM				
C	EXTERNAL & INTERNAL WALLING				
D	ROOFING				
E	OPENNINGS				
F	FINISHES				
G	Provide Kenya Shillings TEN Thousand (Kshs.10,000.00) only for Branding and Sign post				
H	Provide Kenya Shillings Twenty Thousand (Kshs. 20,000.00) only for supply and delivery of English type WC with necessary accessories to approval. .				
<b>TOTAL FOR GIRLS PIT LATRINES CARRIED TO GRAND SUMMARY</b>					

**PROJECT MANAGEMNT EXPENSES**

ITEM	DESCRIPTION	QTY	UNIT	RATE	TOTAL
A	<p><u>PROJECT MANAGEMNT EXPENSES</u></p> <p><u>The following provisional items shall be measured on completion of the works and priced in accordance with rates contained in these bills of quantities or pro-rata thereto or deducted in whole if not required.</u></p> <p>Provide Kenya Shillings Eighty Thousand (Kshs. 80,000.00) only for project administration .</p>		SUM		
	Total for provisional sums carried to grand summary				

ITEM	DESCRIPTION	QTY	UNIT	RATE	TOTAL
	<b>GRAND SUMMARY</b>				
1	GIRLS PIT LATRINES				
A	<b>QUOTED PRICE</b>				
B	VAT (16% of A)				
C	ADD PC & PROVISIONAL SUMS				
D	TOTAL CARRIED TO FORM OF TENDER				

COMPANY SEAL/STAMP.....

SIGNATURE.....

DATE.....

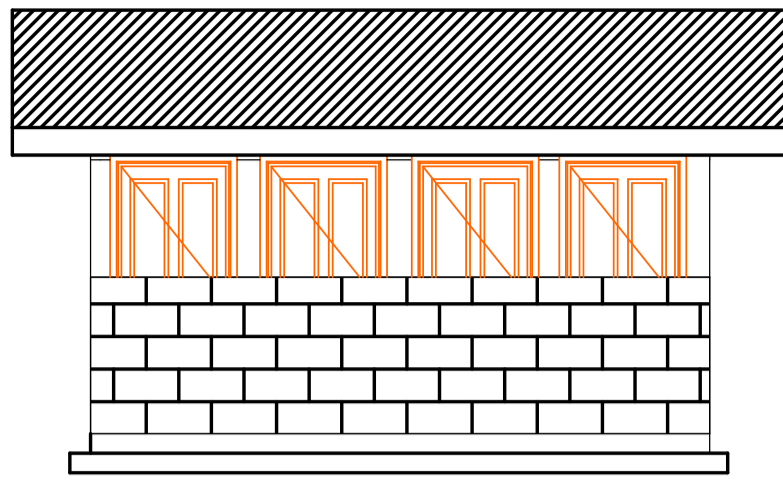

**Elevation (01)**

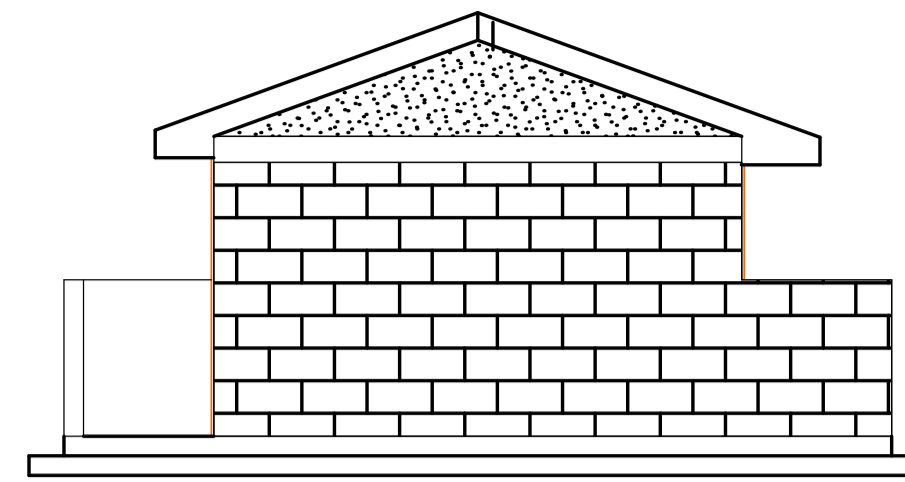

**Elevation(04)**

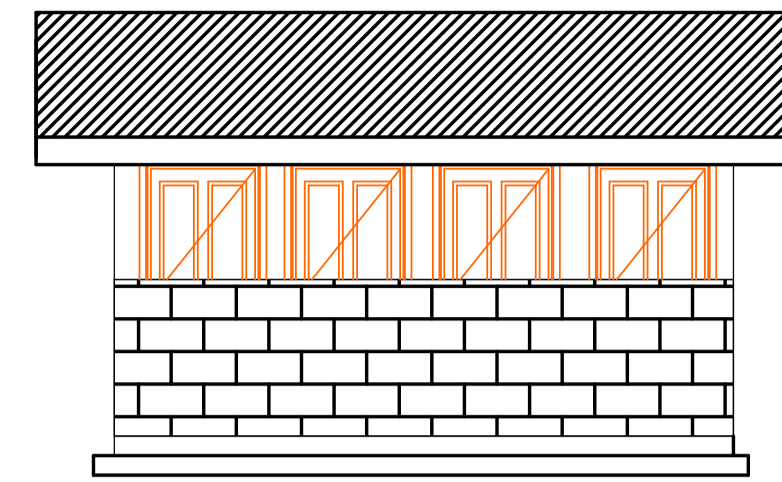

**Elevation(02)**

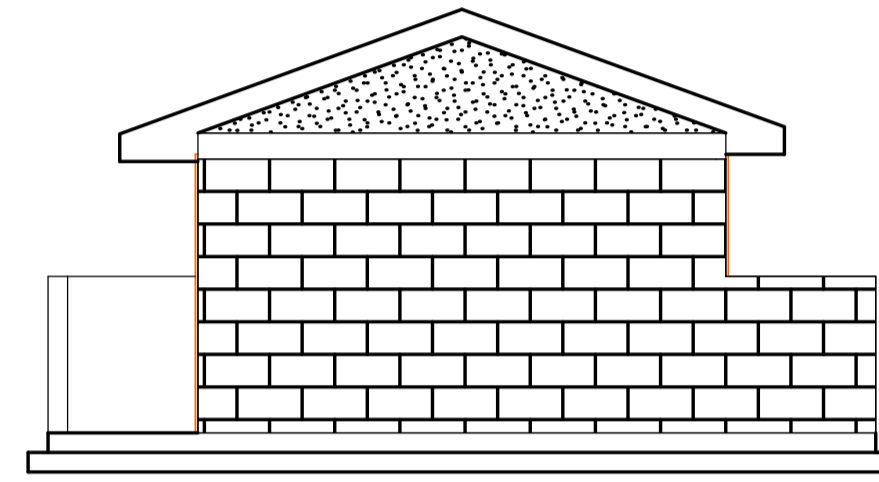

**Elevation(03)**

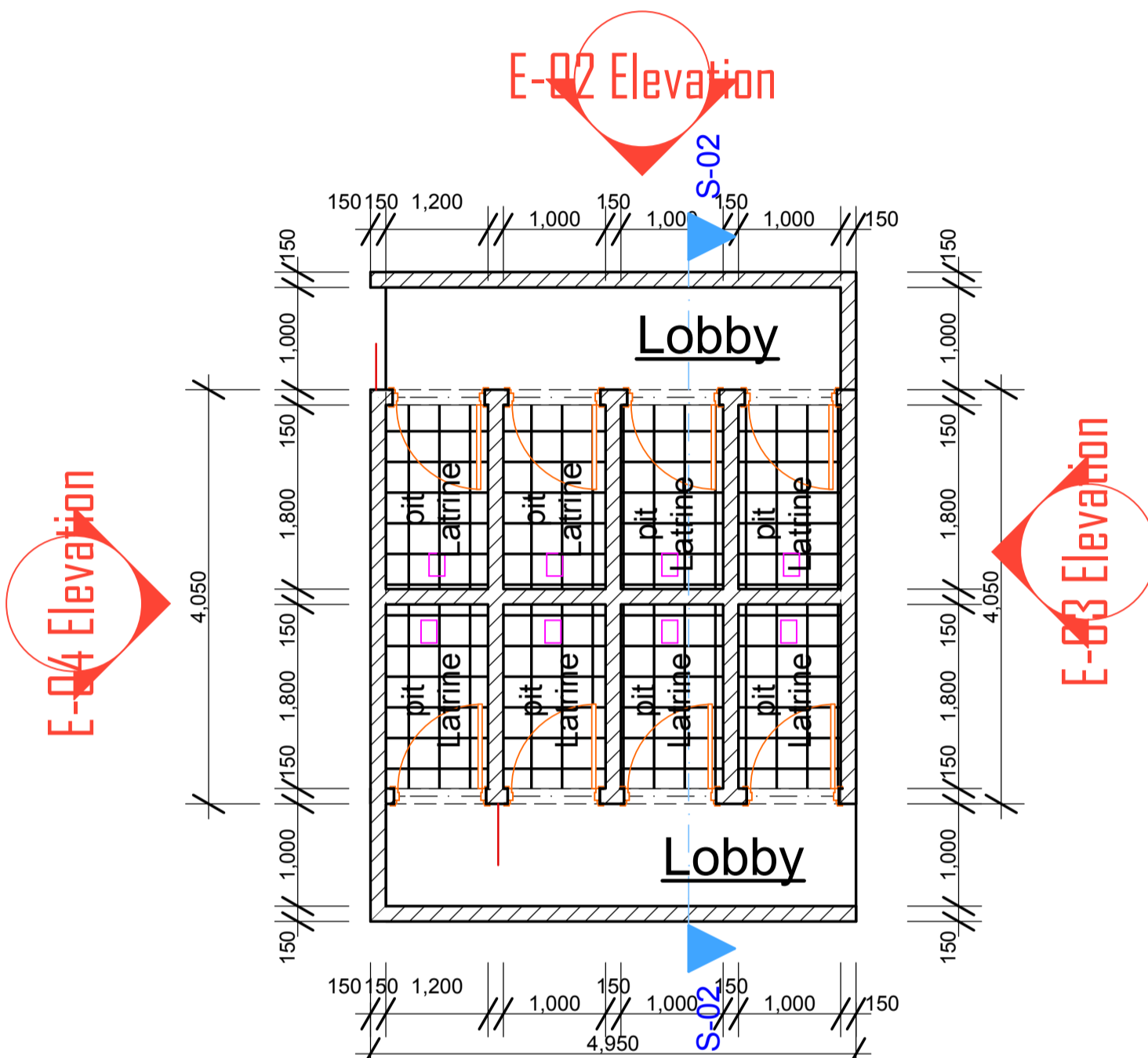

**Ground floor plan**

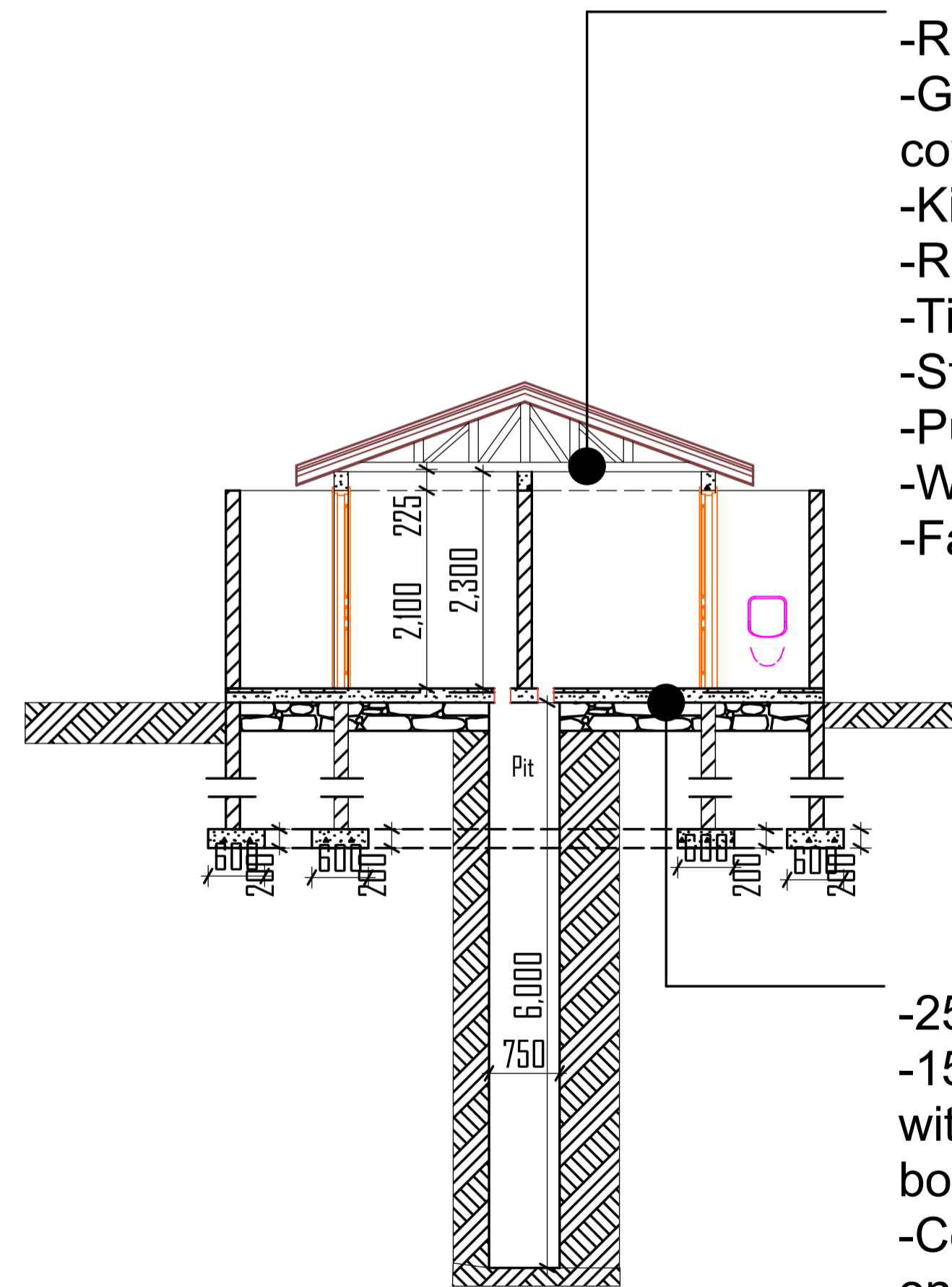

**Cross section S-01<>S-01**

- Ridge cap
- Gauge 30 GCI sheets roof covering
- King post 100X50
- Rafters 100X50
- Tie beam 100X50
- Struts 75X50
- Purlins 75X50
- Wall plate 100X50
- Fascia board 200X25

- 25mm cem scrd ff
- 150mm oversite concrete floor slab with Y10 bar place at 200c/c bothways
- Cedar post laid on 100cc facing one side
- 300mm thick approved hardcore well compacted

**Notes**

- 1.All dimensions are shown in mm unless otherwise specified
- 2.Drawing are not to be scaled.Only figured dimensions to used.
- 3.The contractor must check and verify all dimensions on site before commencement of any work.
- 4.Any discrepancies discovered must be reported to the project architects immediately.
- 5.HOOP IRON to be put in every alternate courses
- 6.PV Denotes (permanent vents)must be installed above all openings except sho/ wc
- 7.DPC Denotes (dump proof course) must be placed under all walls above 150mm ground l

**Construction&civil works**

- 1.All slabs at ground level to be poured over 1000 gauge polythene sheeting on50mm stone dust on Hardcore
- 2.All soil under slabs and all around external foundations to be poisoned for termite control
- 3.All soil on cut embankments to be stabilized.The slope not to exceed the natural angle of refuse

**Structural**

- 1.All black cotton soils to be removed from belowll building and paved surfaces .Building to be clear of black cotton soil to a distance of 3m.
- 2.All paved surfaces to be clear of black cotton to a distance of 500mm outside the edge of surface
- 3.For all R.C work refer to Engineers details.
- 4.Depth of foundation to be determined on the site to S.E's approval

Client:

**OLOSIRO PRIMARY SCH.**

Project:

Org title:

- Floor plan
- Elevations
- cross section

**REVISIONS**

Date	Remarks	Signature

Designed by: <b>L.W.K</b>	Date: <b>APRIL 2025</b>	Phone no:
Drawn by: <b>C.O.O</b>	Date: <b>APRIL 2025</b>	Phone no:
Scale: <b>1:75</b>	Org no:	